

STRALCIO PLANIMETRICO CATASTALE

Comune di Dolo - Foglio X,

Scala 1:2000

Allegato "E" ai nn. 27545 rep. 11428 fasc.

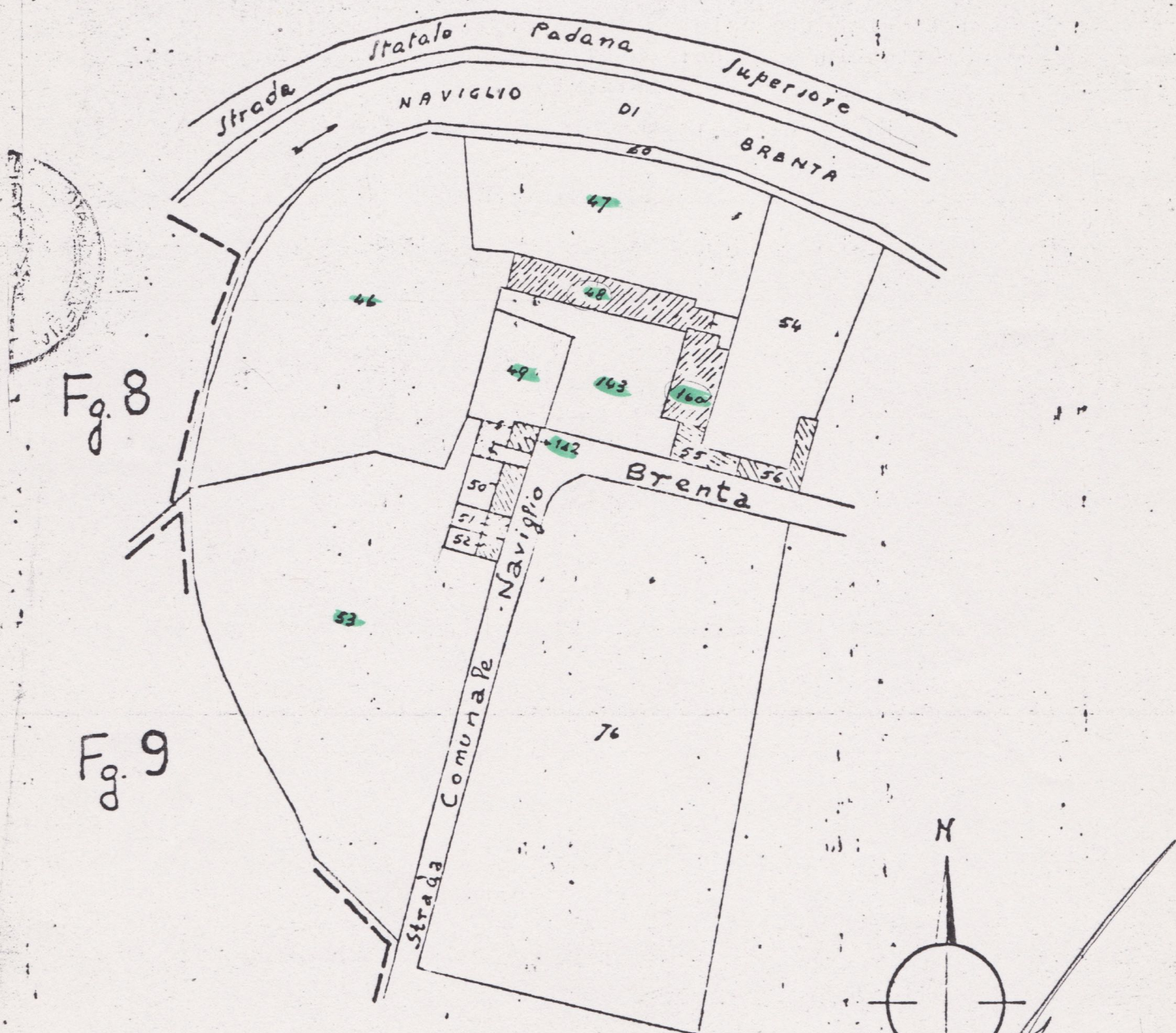

Luigi...
Elio Zamboni
Rappresentante

Proprietà "NAGARA" Immobiliare S.p.A.



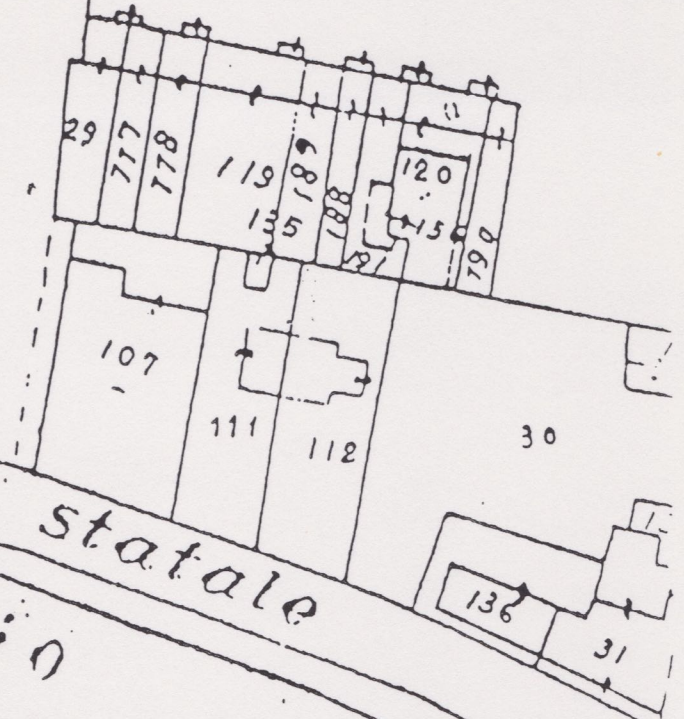
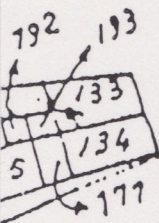

statale
Naviclio

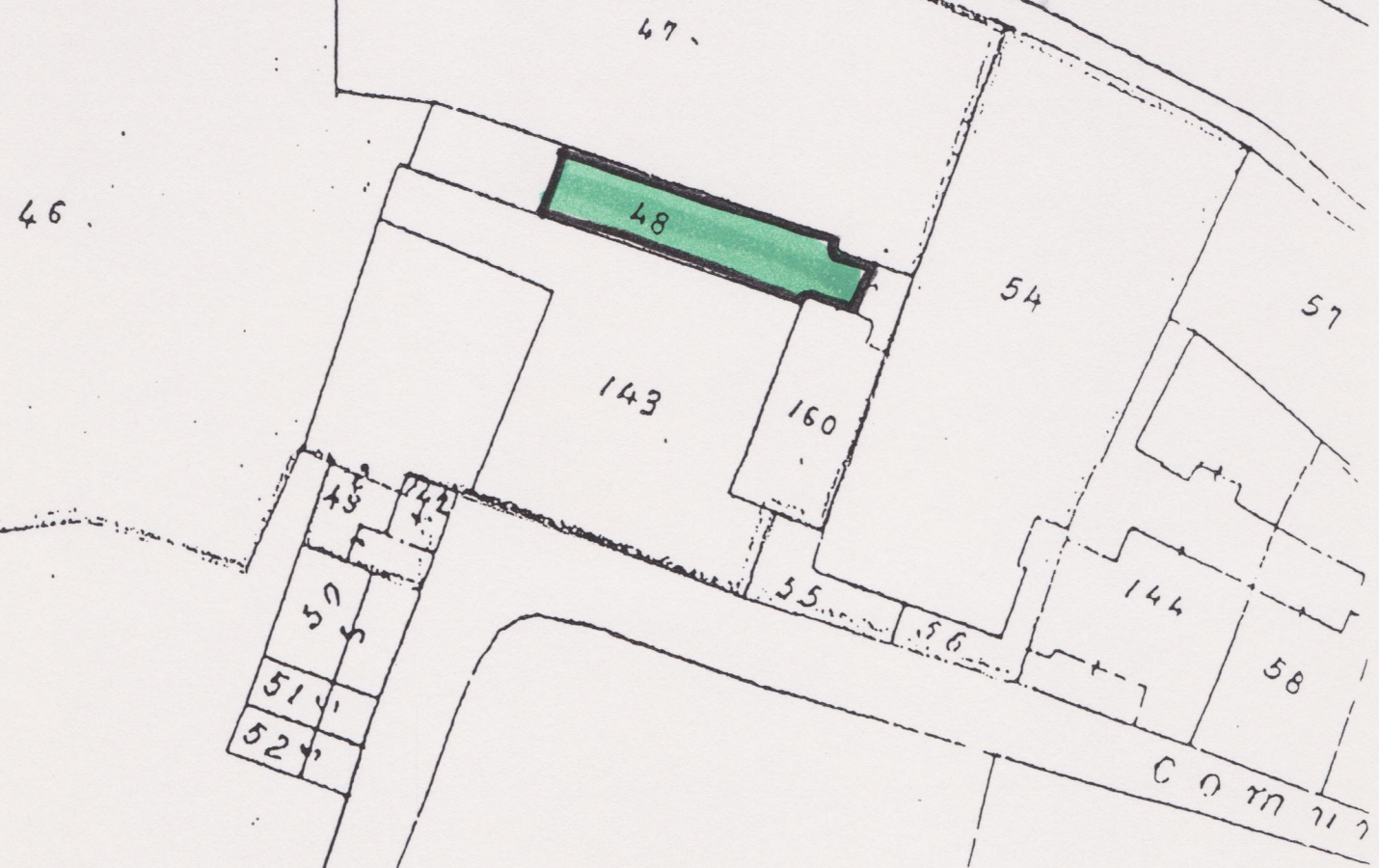

53

C O R R I D O